

Hydraulics

Blackmer 2010 & 2020 Hydrive Cooler.....	129
DRUM DH3.....	130
DRUM DH5.....	130
DRUM MH1 Hydradrive.....	130
DRUM MH3 Hydradrive.....	130
Hydraulic Fittings.....	131-140
Quick Connect Fittings.....	140
Hydraulic Couplers.....	141
Dust Plugs and Caps.....	141
Hydralite Hose.....	142
Flow Control Valve.....	142
Stainless Steel Teflon Hose.....	142
Kuriyama Temp Tech Hose.....	142
Alfatech Constant Working Pressure Hoses.....	142

Blackmer 2010 & 2020 Hydrive Cooler

Unique Design

Compact size allows for easy installation on tractors and trucks with minimal space on chassis rails. The compact design with a low noise level centrifugal fan provides maximum performance and heat dissipation up to 13.5 HP (10kW) on 2010 models and 26 HP (20kW) on 2020 models.

Built for Performance

Constructed from stainless steel materials to withstand the harsh environmental and operation conditions. The light weight cooler with a small hydraulic oil reservoir, reduces the concern and hazard of costly spills.

Maintenance Friendly

The easy to read restriction gauge mounted on the front of the Hydrive indicates when the spin-on oil filter should be replaced. Normal hydraulic oil maintenance is made easy with the reservoir drain on the Hydrive tank.

For a full parts break out of replacement parts please refer to:

Appendix M-11 thru M-13 for Hydrive 2010

Appendix M-14 thru M-16 for Hydrive 2020

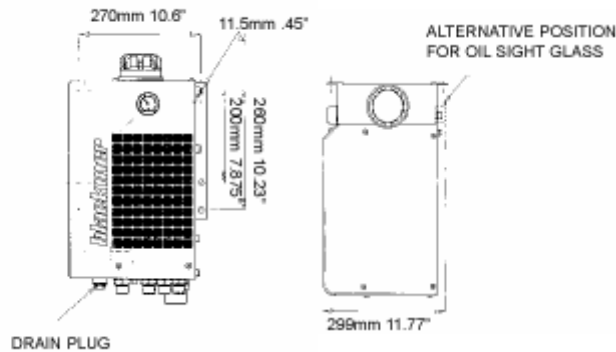
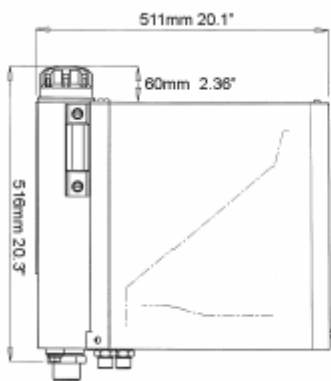

Hydrive 2010



Hydrive 2020

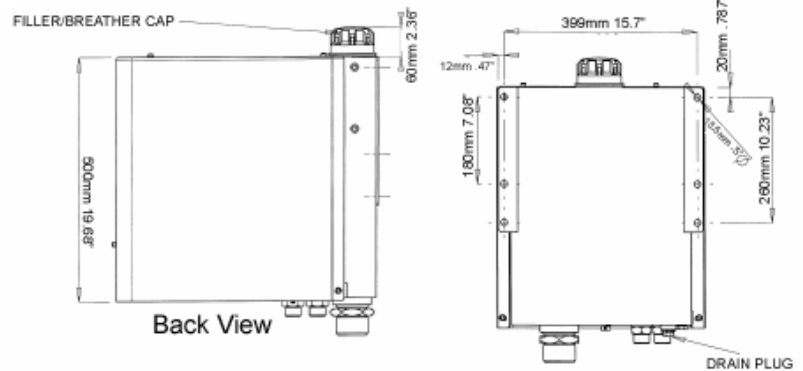
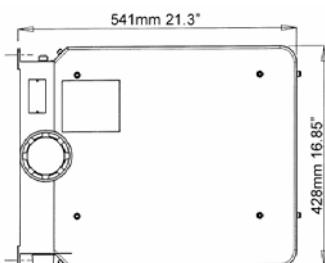

DRUM Hydraulic Coolers



DRUM DH3

A compact, lightweight high efficiency hydraulic control module for operation of product transfer systems. The Hydrapak DH3 controls oil temperature, hydraulic pressure, and oil friction. The DH3 allows for continuous high horsepower operation, while being easy to install and operate with virtually no maintenance.

For full parts breakout refer to **Appendix M-1**

DRUM DH5

A compact, lightweight, high efficiency hydraulic control module for the operation of high horsepower and high flow mobile hydraulic drive systems. The DH5 controls oil temperature, hydraulic pressure, and oil filtration. The DH5 allows for continuous high horsepower operation, is easy to install, operates with virtually no maintenance, and weighs hundreds of pounds less than conventional reservoir type systems.

For full parts breakout refer to **Appendix M-3**



DRUM MH1 Hydrapak



The MH1 is the smallest and lightest in the Drum Hydrapak product range. The MH1 Hydrapak along with a complete Drum Hydraulic system provides a cost-effective means of driving low horsepower product transfer pumps. The systems are ideal on bobtail delivery trucks for propane, fuel oil, bulk oil, and milk. Multiple pump vehicles and vehicles with hose reels also are ideal for the MH1 Hydrapak.

For full parts breakout refer to **Appendix M-5**

DRUM MH3 Hydrapak

The MH3 is a pre-engineered, highly efficient, hydraulic oil cooling package. It includes the oil reservoir, cooler, return line filter and system relief valve. All components are designed into a small, lightweight, quiet and efficient machine.

For full parts breakout refer to **Appendix M-9**



Hydraulic Fittings

In this section our most popular hydraulic fittings are listed. If you do not see the hydraulic fitting you are looking for, call us and we can get it for you. DBL is regularly adding items to its stock to keep up with the demands of its customers.

2403 Male Tube Union

PART NO	TUBE OD	B (1)	B (2)	L1	C	D (1)	D (2)
HYD2403-8-8	1/2 , 1/2	3/4-16	3/4-16	1.62	0.81	0.39	0.39
HYD2403-12-8	3/4, 1/2	1 ¹ / ₁₆ -12	3/4-16	1.95	1.13	0.61	0.39
HYD2403-12-12	3/4, 3/4	1 ¹ / ₁₆ -12	1 ¹ / ₁₆ -12	2.16	1.13	0.61	0.61
HYD2403-16-12	1, 3/4	1 ⁵ / ₁₆ -12	1 ¹ / ₁₆ -12	2.20	1.38	0.84	0.61
HYD2403-16-16	1, 1	1 ⁵ / ₁₆ -12	1 ⁵ / ₁₆ -12	2.25	1.38	0.84	0.84

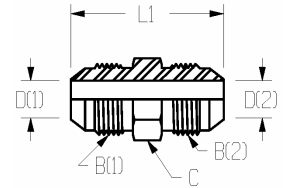

2404 Male Connector

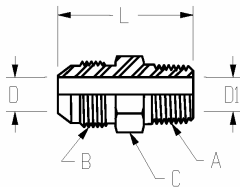

PART NO	TUBE OD	B (1)	A	L	C	D	D (1)
HYD2404-8-6	1/2	3/4-16	3/8-18	1.53	0.81	0.39	0.41
HYD2404-8-8	1/2	3/4-16	1/2-14	1.79	0.88	0.39	0.53
HYD2404-8-8SS	1/2	3/4-16	1/2-14	1.79	0.88	0.39	0.53
HYD2404-8-12	1/2	3/4-16	3/4-14	1.85	1.13	0.39	0.72
HYD2404-12-8	3/4	1 ¹ / ₁₆ -12	1/2-14	2.06	1.13	0.61	0.53
HYD2404-12-12SS	3/4	1 ¹ / ₁₆ -12	3/4-14	2.06	1.13	0.61	0.72
HYD2404-12-12	3/4	1 ¹ / ₁₆ -12	3/4-14	2.06	1.13	0.61	0.72
HYD2404-12-16	3/4	1 ¹ / ₁₆ -12	1-11 ¹ / ₂	2.25	1.38	0.61	0.94
HYD2404-16-8	1	1 ⁵ / ₁₆ -12	1/2-14	2.11	1.38	0.84	0.53
HYD2404-16-12	1	1 ⁵ / ₁₆ -12	3/4-14	2.11	1.38	0.84	0.72
HYD2404-16-16	1	1 ⁵ / ₁₆ -12	1-11 ¹ / ₂	2.30	1.38	0.84	0.94

2405 Female Connector

PART NO	TUBE OD	B	A	L2	C1	D	Tap Drill
HYD2405-8-8	1/2	3/4-16	1/2-14	1.79	1.13	0.39	0.70
HYD2405-8-12	1/2	3/4-16	3/4-14	1.85	1.38	0.39	0.91
HYD2405-12-8	3/4	1 ¹ / ₁₆ -12	1/2-14	2.05	1.13	0.61	0.71
HYD2405-12-12	3/4	1 ¹ / ₁₆ -12	3/4-14	2.06	1.38	0.61	0.91
HYD2405-12-16	3/4	1 ¹ / ₁₆ -12	1-11 ¹ / ₂	2.30	1.63	0.61	1.14
HYD2405-16-12	1	1 ⁵ / ₁₆ -12	3/4-14	2.12	1.38	0.84	0.91
HYD2405-20-20	1 ¹ / ₄	1 ⁵ / ₈ -12	1 ¹ / ₄ -11 ¹ / ₂	2.49	2.00	1.08	1.48

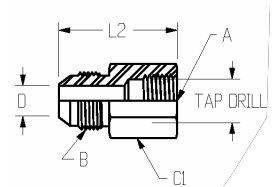

2406 Reducing Adapter (One Piece)

PART NO	TUBE OD	B (1)	B (2)	L23	C	D (1)
HYD2406-12-16	3/4, 1	1 ¹ / ₁₆ -12	1 ⁵ / ₁₆ -12	1.61	1.38	0.61
HYD2406-16-12	1, 3/4	1 ⁵ / ₁₆ -12	1 ¹ / ₁₆ -12	1.82	1.50	0.61

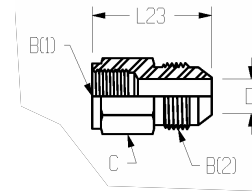

2408 Male Tube Plug

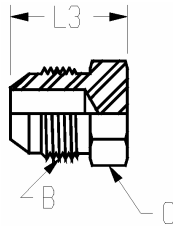

PART NO	TUBE OD	B	L3	C
HYD2408-6	3/8	9/16-18	0.84	0.63
HYD2408-8	1/2	3/4-16	0.94	0.81
HYD2408-10	5/8	7/8-14	1.10	0.94
HYD2408-12	3/4	1 ¹ / ₁₆ -12	1.28	1.13
HYD2408-16	1	1 ⁵ / ₁₆ -12	1.33	1.38
HYD2408-20	1 ¹ / ₄	1 ⁵ / ₈ -12	1.45	1.69

2501 90° Male Elbow

PART NO	TUBE OD	B	A	M	N	Y	D	D1
HYD2501-8-8	1/2	3/4-16	1/2-14	1.31	1.47	0.94	0.39	0.53
HYD2501-12-12	3/4	1 ¹ / ₁₆ -12	3/4-14	1.66	1.59	1.13	0.61	0.72
HYD2501-12-16	3/4	1 ¹ / ₁₆ -12	1-11 ¹ / ₂	1.78	1.97	1.38	0.61	0.94
HYD2501-16-12	1	1 ⁵ / ₁₆ -12	3/4-14	1.81	1.72	1.38	0.84	0.72
HYD2501-16-16	1	1 ⁵ / ₁₆ -12	1-11 ¹ / ₂	1.81	1.97	1.38	0.84	0.94

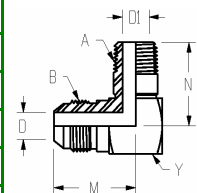

2502 90° Female Elbow

PART NO	TUBE OD	B	A	M1	N1	Y1	D	Tap Drill
HYD2502-8-8	1/2	3/4-16	1/2-14	1.03	0.66	0.63	0.13	0.33
HYD2502-12-12	3/4	1 ¹ / ₁₆ -12	3/4-14	1.89	1.36	1.38	0.61	0.91
HYD2502-16-12	1	1 ⁵ / ₁₆ -12	3/4-14	2.05	1.36	1.38	0.84	0.91

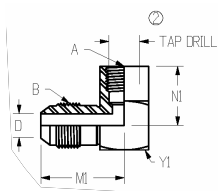

2700-LN Bulkhead Union

PART NO	TUBE OD	B (1)	B (2)	L4	I1	C2	D(1)	D(2)
HYD2700LN-8-8	1/2, 1/2	5/16-24	5-16/24	2.44	1.44	1.00	0.39	0.39
HYD2700LN-10-10	5/8, 5/8	7/8-14	7/8-14	2.74	1.58	1.13	0.48	0.48
HYD2700LN-12-12	3/4, 3/4	1 ¹ / ₁₆ -12	1 ¹ / ₁₆ -12	3.09	1.75	1.38	0.61	0.61
HYD2700LN-16-12	1, 3/4	1 ⁵ / ₁₆ -12	1 ¹ / ₁₆ -12	3.14	1.75	1.63	0.84	0.61

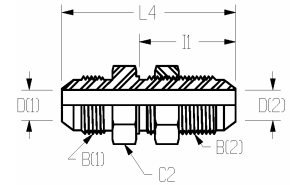

2701-LN 90° Bulkhead Elbow

PART NO	TUBE OD	B (1)	B (2)	M4	M4	I2	K1	O	Y	D(1)	D(2)
HYD2701LN-8-6	1/2, 3/8	3/4-16	9/16-18	1.36	1.91	1.09	0.09	0.69	0.81	0.39	0.30
HYD2701LN-10-10	5/8, 5/8	7/8-14	7/8-14	1.56	2.39	1.39	0.13	1.00	0.94	0.48	0.48
HYD2701LN-12-12	3/4, 3/4	1 ¹ / ₁₆ -12	1 ¹ / ₁₆ -12	1.78	2.67	1.56	0.13	1.19	1.13	0.61	0.61
HYD2700LN-16-16	1, 1	1 ⁵ / ₁₆ -12	1 ⁵ / ₁₆ -12	1.94	2.80	1.56	0.13	1.44	1.38	0.84	0.84

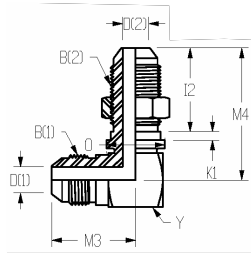

2702-LN 45° Bulkhead Elbow

PART NO	TUBE OD	B (1)	B (2)	M2	M9	I2	K1	O	Y	D(1)	D(2)
HYD2702LN-8-8	1/2, 1/2	3/4-16	3/4-16	0.98	1.94	1.25	0.13	0.88	0.81	0.39	0.39
HYD2702LN-10-10	5/8, 5/8	7/8-14	7/8-14	1.11	2.17	1.39	0.13	1.00	0.94	0.48	0.48
HYD2702LN-12-12	3/4, 3/4	1 ¹ / ₁₆ -12	1 ¹ / ₁₆ -12	1.28	2.44	1.56	0.13	1.19	1.13	0.61	0.61
HYD2702LN-16-16	1, 1	1 ⁵ / ₁₆ -12	1 ⁵ / ₁₆ -12	1.47	2.53	1.56	0.13	1.44	1.38	0.84	0.84

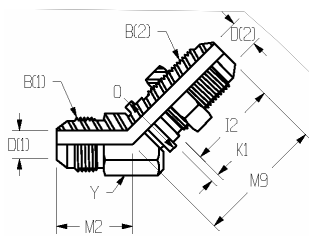

2706-LN Male Pipe/Bulkhead

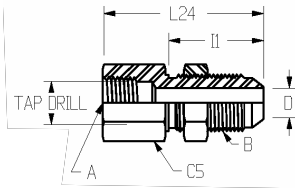

PART NO	TUBE OD	A	B	L25	I1	C2	D1	D
HYD2706LN-12-12	3/4	3/4-14	1 ¹ / ₁₆ -12	2.92	1.75	1.38	0.72	0.61
HYD2706LN-16-16	1	1-11 ¹ / ₂	1 ⁵ / ₁₆ -12	3.11	1.75	1.63	0.94	0.84

304-C Cap Nut

PART NO	TUBE OD	B	L2	C
HYD304-C-6	3/8	9/16-18	0.63	0.69
HYD304-C-8	1/2	3/4-16	0.75	0.88
HYD304-C-10	5/8	7/8-14	0.84	1.00
HYD304-C-12	3/4	1 ¹ / ₁₆ -12	0.91	1.25
HYD304-C-16	1	1 ⁵ / ₁₆ -12	1.02	1.50

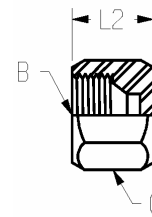

5404 Hexagon Pipe Nipple

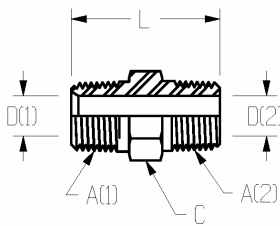

PART NO	A(1)	A(2)	L	C	D (1)	D (2)
HYD5404-12-8	3/4-14	1/2-14	1.96	1.13	0.72	0.53
HYD5404-16-12	1-11 ¹ / ₂	3/4-14	2.15	1.38	0.94	0.72

5502 90° Street Elbow

PART NO	A(1)	A(2)	N	N1	W	D	Tap Drill
HYD5502-8-8	1/2-14	1/2-14	1.47	1.23	1.13	0.53	0.70
HYD5502-12-12	3/4-14	3/4-14	1.59	1.36	1.38	0.72	0.91
HYD5502-16-16	1-11 ¹ / ₂	1-11 ¹ / ₂	1.97	1.62	1.63	0.94	1.14

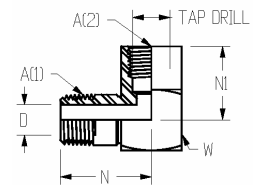

5503 45° Street Elbow

PART #	A(1)	A(2)	N4	N3	W	D	Tap Drill
HYD5503-8-8	1/2-14	1/2-14	1.34	0.91	1.13	0.53	0.70
HYD5503-12-12	3/4-14	3/4-14	1.38	0.97	1.38	0.72	0.91
HYD5503-16-16	1-11 ¹ / ₂	1-11 ¹ / ₂	1.72	1.12	1.63	0.94	1.14

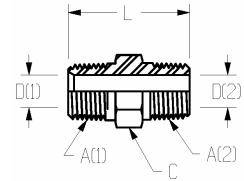

6400 Straight Thread Adapter

PART NO	TUBE OD	B (1)	B (2)	L5	C4	D (1)	D (2)
HYD6400-6-6	3/8	9/16-18	9/16-18	1.30	0.69	0.30	0.30
HYD6400-8-8	1/2	3/4-16	3/4-16	1.48	0.88	0.39	0.39
HYD6400-8-10	1/2	3/4-16	7/8-14	1.60	1.00	0.39	0.48
HYD6400-8-12	1/2	3/4-16	1 ¹ / ₁₆ -12	1.76	1.25	0.39	0.61
HYD6400-8-16	1/2	3/4-16	1 ⁵ / ₁₆ -12	1.79	1.50	0.39	0.84
HYD6400-10-8	5/8	7/8-14	3/4-16	1.64	0.94	0.48	0.39
HYD6400-10-12	5/8	7/8-14	1 ¹ / ₁₆ -12	1.86	1.25	0.48	0.61
HYD6400-12-8	3/4	1 ¹ / ₁₆ -12	3/4-16	1.94	1.13	0.61	0.39
HYD6400-12-10	3/4	1 ¹ / ₁₆ -12	7/8-14	1.88	1.13	0.61	0.48
HYD6400-12-12	3/4	1 ¹ / ₁₆ -12	1 ¹ / ₁₆ -12	1.97	1.25	0.61	0.61
HYD6400-12-16	3/4	1 ¹ / ₁₆ -12	1 ⁵ / ₁₆ -12	1.99	1.50	0.61	0.84
HYD6400-16-8	1	1 ⁵ / ₁₆ -12	3/4-16	2.01	1.38	0.84	0.39
HYD6400-16-12	1	1 ⁵ / ₁₆ -12	1 ¹ / ₁₆ -12	2.04	1.38	0.84	0.61
HYD6400-16-16	1	1 ⁵ / ₁₆ -12	1 ⁵ / ₁₆ -12	2.04	1.50	0.84	0.84
HYD6400-16-20	1	1 ⁵ / ₁₆ -12	1 ⁵ / ₈ -12	2.12	1.88	0.84	1.08
HYD6400-20-16	1 ¹ / ₄	1 ⁵ / ₈ -12	1 ⁵ / ₁₆ -12	2.33	1.69	1.08	0.84
HYD6400-20-20	1 ¹ / ₄	1 ⁵ / ₈ -12	1 ⁵ / ₈ -12	2.17	1.88	1.08	1.08
HYD6400-20-24	1 ¹ / ₄	1 ⁵ / ₈ -12	1 ⁷ / ₈ -12	2.24	2.13	1.08	1.31
HYD6400-24-16	1 ¹ / ₂	1 ⁷ / ₈ -12	1 ⁵ / ₁₆ -12	2.53	2.00	1.31	0.84
HYD6400-24-20	1 ¹ / ₂	1 ⁷ / ₈ -12	1 ⁵ / ₈ -12	2.53	2.00	1.31	1.08

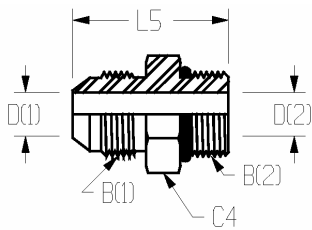

6401 Straight Thread/Male Pipe Adapter

PART NO	B	A	L29	C4	D	D(1)
HYD6401-12-12	1 ¹ / ₁₆ -12	3/4-14	1.73	1.25	0.61	0.72

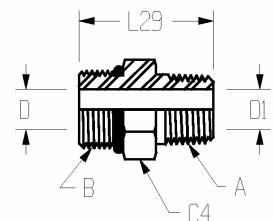

6405 Straight Thread/Female Pipe Adapter

PART NO	B	A	L31	C1	D	Tap Drill
HYD6405-8-8	3/4-16	1/2-14	1.63	1.13	0.39	0.70
HYD6405-8-12	3/4-16	3/4-14	1.63	1.38	0.39	0.91
HYD6405-12-8	1 ¹ / ₁₆ -12	1/2-14	1.50	1.25	0.61	0.70
HYD6405-12-12	1 ¹ / ₁₆ -12	3/4-14	1.59	1.38	0.61	0.91
HYD6405-12-16	1 ¹ / ₁₆ -12	1-11 ¹ / ₂	1.95	1.63	0.61	1.14
HYD6405-16-12	1 ⁵ / ₁₆ -12	3/4-14	1.62	1.50	0.84	0.91
HYD6405-16-16	1 ⁵ / ₁₆ -12	1-11 ¹ / ₂	1.90	1.63	0.84	1.14

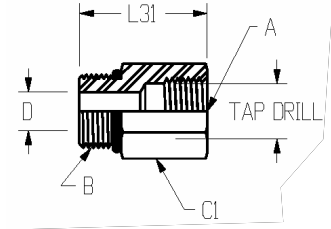

6408 Hexagon Head O-Ring Boss Plug

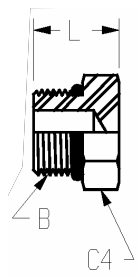

PART NO	B	L	C4
HYD6408-6	9/16-18	0.73	0.69
HYD6408-8	3/4-16	0.80	0.88
HYD6408-10	7/8-14	0.93	1.00
HYD6408-12	1 ¹ / ₁₆ -12	1.09	1.25
HYD6408-16	1 ⁵ / ₁₆ -12	1.12	1.50
HYD6408-20	1 ⁵ / ₈ -12	1.20	1.88
HYD6408-24	1 ⁷ / ₈ -12	1.27	2.13

6500 90° Swivel Elbow

PART NO	TUBE OD	B (1)	B (2)	M	M5	M10	C3	Y	D(1)	D(2)
HYD6500-6-6	3/8, 3/8	9/16-18	9/16-18	1.06	1.25	0.88	0.69	0.63	0.30	0.30
HYD6500-8-8	1/2, 1/2	3/4-16	3/4-16	1.25	1.38	0.96	0.88	0.81	0.39	0.39
HYD6500-10-10	5/8, 5/8	7/8-14	7/8-14	1.45	1.62	1.12	1.00	0.94	0.48	0.48
HYD6500-12-12	3/4, 3/4	1 ¹ / ₁₆ -12	1 ¹ / ₁₆ -12	1.66	1.75	1.19	1.25	1.13	0.61	0.61
HYD6500-16-12	1, 3/4	1 ⁵ / ₁₆ -12	1 ¹ / ₁₆ -12	1.81	1.88	1.31	1.25	1.38	0.84	0.61
HYD6500-20-20	1 ¹ / ₄ , 1 ¹ / ₄	1 ⁵ / ₈ -12	1 ⁵ / ₈ -12	2.06	2.31	1.68	2.00	1.75	1.08	1.08

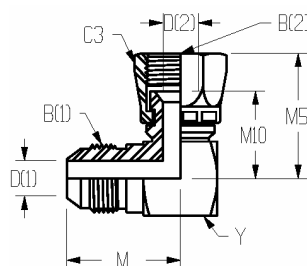

6502 45° Swivel Elbow

PART NO	TUBE OD	B (1)	B (2)	M2	M6	M14	C3	Y	D(1)	D(2)
HYD6502-8-8	1/2, 1/2	3/4-16	3/4-16	0.98	1.28	0.86	0.88	0.81	0.39	0.39
HYD6502-10-10	5/8, 5/8	7/8-14	7/8-14	1.11	1.44	0.94	1.00	0.94	0.48	0.48
HYD6502-12-12	3/4, 3/4	1 ¹ / ₁₆ -12	1 ¹ / ₁₆ -12	1.28	1.50	0.94	1.25	1.13	0.61	0.61
HYD6502-16-16	1, 1	1 ⁵ / ₁₆ -12	1 ⁵ / ₁₆ -12	1.47	1.75	1.16	1.50	1.38	0.84	0.84
HYD6502-20-20	1 ¹ / ₄ , 1 ¹ / ₄	1 ⁵ / ₁₆ -12	1 ⁵ / ₁₆ -12	1.59	1.96	1.34	2.00	1.75	1.08	1.08
HYD6502-24-24	1 ¹ / ₂ , 1 ¹ / ₂	1 ⁷ / ₈ -14	1 ⁷ / ₈ -14	1.78	2.25	1.52	2.25	2.00	1.31	1.31

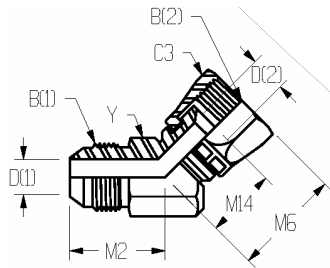

6801 90° Straight Thread

PART NO	TUBE OD	B (1)	B (2)	M	M7	C4	Y	D(1)	D(2)
HYD6801-8-8	1/2	3/4-16	3/4-16	1.25	1.45	0.88	0.81	0.39	0.39
HYD6801-8-12	1/2	3/4-16	1 ¹ / ₁₆ -12	1.40	1.94	1.25	1.13	0.39	0.61
HYD6801-12-8	3/4	1 ¹ / ₁₆ -12	3/4-16	1.66	1.61	0.88	1.13	0.61	0.39
HYD6801-12-10	3/4	1 ¹ / ₁₆ -12	7/8-14	1.66	1.80	1.00	1.13	0.61	0.48
HYD6801-12-12	3/4	1 ¹ / ₁₆ -12	1 ¹ / ₁₆ -12	1.66	1.94	1.25	1.13	0.61	0.61
HYD6801-12-16	3/4	1 ¹ / ₁₆ -12	1 ⁵ / ₁₆ -12	1.78	2.05	1.50	1.38	0.61	0.84
HYD6801-16-12	1	1 ⁵ / ₁₆ -12	1 ¹ / ₁₆ -12	1.81	2.06	1.25	1.38	0.84	0.61
HYD6801-16-16	1	1 ⁵ / ₁₆ -12	1 ⁵ / ₁₆ -12	1.81	2.05	1.50	1.38	0.84	0.84

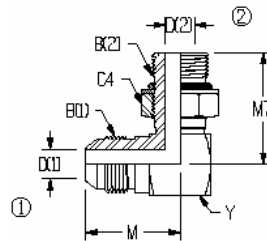

NPTF Swivel Male Stem

PART NO	Hose ID	Thread	Hex	Stem ID	Fitting Length	CO Cutoff
HYDC8MPS	1/2	1/2 -14	1	.406	2.955	1.800
HYDC12MPS	3/4	3/4 -14	1 ⁵ / ₁₆	.625	3.135	1.885
HYDC16MPS	1	1 ¹ / ₄ -11 ¹ / ₂	1 ⁵ / ₈	.937	4.395	2.480

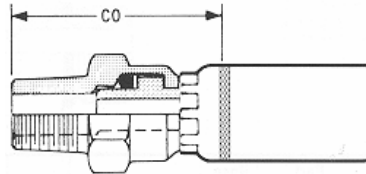
**NPTF Solid Male Stem**

PART NO	Hose ID	Thread	Hex	Stem ID	Fitting Length	CO Cutoff
HYDC8MP	1/2	1/2 -18	7/8	.406	2.472	1.312
HYDC12MP	3/4	3/4 -14	1 ¹ / ₁₆	.625	2.676	1.526

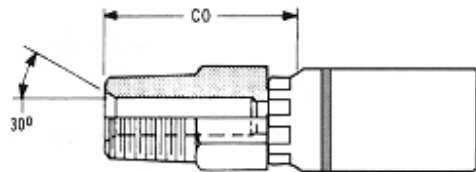
**JIC 37° Swivel Female Stem**

PART NO	Hose ID	Thread	Stem Hex	Nut Hex	Stem ID	Fitting Length	CO Cutoff
HYDC6FJ	3/8	9/16 -18	11/16	3/4	.296	2.030	1.105
HYDC86FJ	1/2	9/16 -18	13/16	3/4	.296	2.340	1.165
HYDC8FJ	1/2	3/4 -16	13/16	7/8	.406	2.470	1.310
HYDC10FJ	5/8	7/8 -14	1	1 ¹ / ₁₆	.500	2.565	1.405
HYDC1210FJ	3/4	7/8 -14	1 ¹ / ₁₆	1 ¹ / ₁₆	.500	2.745	1.490
HYDC12FJ	3/4	1 ¹ / ₁₆ -12	1 ¹ / ₁₆	1 ¹ / ₄	.625	2.810	1.570
HYDC1612FJ	1	1 ¹ / ₁₆ -12	1 ³ / ₈	1 ¹ / ₄	.718	3.040	1.580
HYDC16FJ	1	1 ⁵ / ₁₆ -12	1 ³ / ₈	1 ¹ / ₂	.844	3.175	1.720

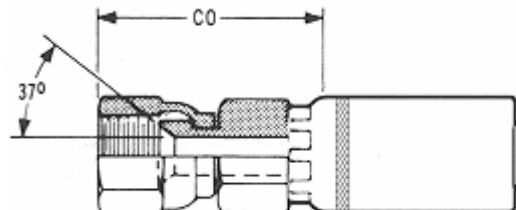

JIC 37° Female Stem-45° Bent Tube-Medium Drop

PART NO	Hose ID	Thread	Hex	D Drop	Fitting Length	CO Cutoff
HYDC8FJ45	1/2	3/4-16	7/8	.690	3.240	2.200
HYDC12FJ45	3/4	1 ¹ / ₁₆ -12	1 ¹ / ₄	1.060	4.020	2.900
HYDC16FJ45	1	1 ⁵ / ₁₆ -12	1 ¹ / ₂	1.160	4.780	3.310

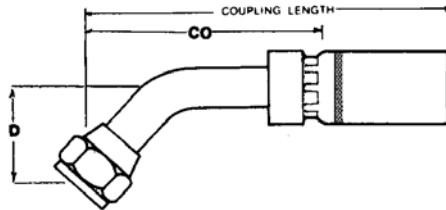

NPTF Swivel Male Stem

PART NO	Hose ID	Thread	Hex	Stem ID	Fitting Length	CO Cutoff
HYDC8FJ90	1/2	3/8-18	1	.406	2.755	1.605
HYDC12FJ90	3/4	1/2-14	1 ⁵ / ₁₆	.625	3.125	1.890
HYDC16FJ90	1	1-11 ¹ / ₂	1 ⁵ / ₈	.844	3.760	2.300

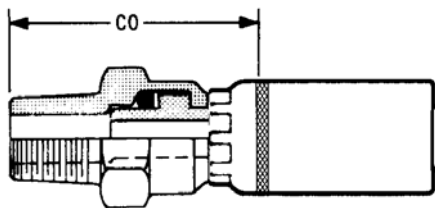

Brass FJIC X Teflon Hose Coupler

Medium pressure, 3 piece fitting, crimped, and with a smooth bore. Made of brass.

Part#	Size
HYDCT8FJ	1/2"
HYDCT12FJ	3/4"

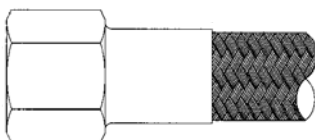

Stainless Steel FJIC X Teflon Hose Coupler

Medium pressure, 3 piece fitting, crimped, and with a smooth bore. Made of stainless steel.

Part#	Description
HYDCT8FJSS	1/2"
HYDCT12FJSS	3/4"

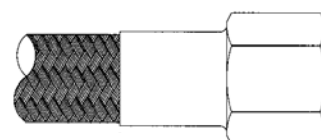

Hydraulic ORB Ball Valve Coupler

Part# **HYD18-415**

1/2" Steel ISO C hydraulic coupler with ORB port.

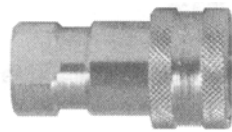

Hydraulic ORB Ball Valve Plug

Part# **HYD19-415**

1/2" Steel ISO C hydraulic plug with ORB port



Agricultural Hydraulic Quick Connect Fitting

Steel ISO C hydraulic fittings with NPT ports. Quick connect features ball style shut-off valves in both the coupler and plug. **Interchangeable with Pioneer 4000 series and Safeway Agricultural series.**



Part#	Description
HYD18-600	Steel 1/2" FPT Coupler
HYD18-660	Steel 3/4" FPT Coupler
HYD19-600	Steel 1/2" FPT Plug
HYD19-660	Steel 3/4" FPT Plug

Dixon 5600 Series Hydraulic Quick-Connect Fittings

The 5600 Series is interchangeable with the Aeroquip 5600, Parker 6600, and ISO A interchange. The two-way check valves in the plug and socket automatically balance in flow position and provide instant shut off when disconnected. Easy and fast connect and disconnect of fluid or gas lines equals minimal loss of product from either end.

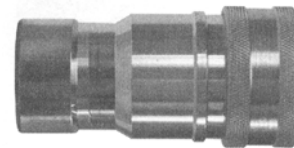
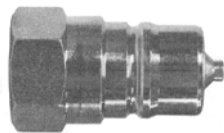

Part#	Body and NPT Thread Size
HYD56-400	1/2" x 1/2"-14
HYD56-600	1/2" x 3/4"-14
HYD56-660	3/4" x 3/4"-14
HYD56-800	1" x 1"-11 1/2

Part#	Body and NPT Thread Size
HYD57-400	1/2" x 1/2"-14
HYD57-600	1/2" x 3/4"-14
HYD57-660	3/4" x 3/4"-14
HYD56-800	1" x 1"-11 1/2

ISO FF 3/4" Hydraulic Coupler and Plug

Steel, flush face ISO16028 hydraulic coupler and plug with an operating pressure of 5000 PSI. **Interchangeable with Aeroquip FD89, Parker FE, Snap-tite 74, Faster FF, and Holmbury Series.**



Part#	Description
HYD6HTF6	3/4" Coupler
HYDHT6F6	3/4" Plug

VH Series 3/4" Hydraulic Coupler and Plug

General purpose hydraulic quick-connect provides superior flow characteristics with built in reliability. Standard seal is Buan-N. Made of zinc plated steel. **Interchangeable with Snap-tite H Series.**

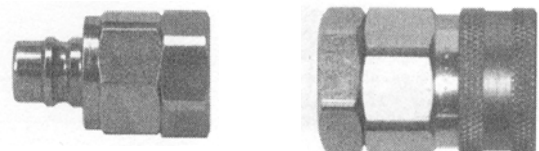

Part#	Description
HYDVHC600	3/4" Coupler
HYDVHN600	3/4" Plug

Parker Hydraulic Coupler and Nipple

Parker spacer Bruning 3/4" steel hydraulic coupler and plug.



Part#	Description
HYDNS751-12FP	3/4" Coupler
HYDNS752-12FP	3/4" Nipple

Safeway Coupler and Adapter

Safeway steel 100 Series hydraulic couplers and adapters.

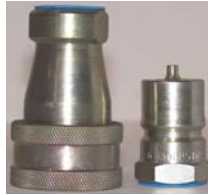

Part#	Description
HYDS105-4	1/2" Coupler
HYDS105-6	3/4" Coupler
HYDS101-4	1/2" Adapter
HYDS101-6	3/4" Adapter

Dixon Hydraulic Coupler with Wing Nut

7800 Series steel hydraulic couplers for agricultural applications. Made of brass. Interchangeable with Aeroquip 5100 series, Parker 6100 series, and Snap-tite 78 series. Widely used on dump trailer wet-line hydraulic systems and oil field equipment.

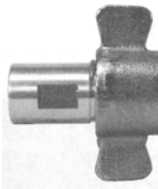

Part#	Size
HYD78-600	3/4"
HYD78-800	1"
HYD78-1000	1-1/4"
HYD78-1200	1-1/2"

Dixon Hydraulic Dust Cap

7800 Series steel hydraulic dust caps for agricultural applications. Made of brass.



Part#	Size
HYD79-006	3/4"
HYD79-008	1"
HYD79-010	1-1/4"
HYD79-012	1-1/2"

Parker 3/4" Coupler and Adapter

Steel Parker SM Series 3/4" coupler and adapter.



Part#	Size
HYDSM501-12FP	3/4" Coupler
HYDSM502-12FP	3/4" Adapter

Tomko Couplers and Adapters

Steel T Series coupler and adapters for use in hydraulic applications. For more information on any hydraulic coupler contact DBL.



Part#	Description
HYDTH6	3/4" Coupler
HYDTH8	1" Coupler
HYDTK6	3/4" Adapter
HYDTK8	1" Adapter

Dixon Hydraulic Dust Plug

7800 Series dust plugs for agricultural applications.



Part#	Size
HYD78-006	3/4"
HYD78-008	1"
HYD78-010	1-1/4"
HYD78-012	1-1/2"

Dixon Hydraulic Plug

7800 Series steel hydraulic plugs for agricultural applications. Made of brass. Interchangeable with Aeroquip 5100 series, Parker 6100 series, and Snap-tite 78 series. Widely used on dump trailer wet-line hydraulic systems and oil field equipment.



Part#	Size
HYD79-600	3/4"
HYD79-800	1"
HYD79-1000	1-1/4"
HYD79-1200	1-1/2"

Hydra-Lite I Wire Braid Hydraulic Hose

One wire high tensile steel braid in sizes 1/4" thru 1/2" and two wire high tensile steel. Black, oil and abrasion resistant Neoprene (CR). MSHA approved braid.

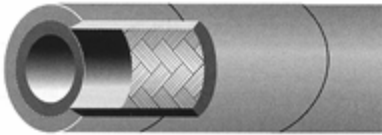

Part#	Description
HYDH6	3/8"
HYDH8	1/2"
HYDH10	5/8"
HYDH12	3/4"

Hydra-Lite II 1" Wire Braid Hydraulic Hose

Part# HYDH16

Two wire braid made of high tensile steel. Black, oil abrasion Neoprene (CR). MSHA approved.

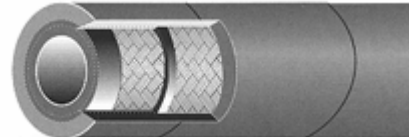

Stainless Steel Teflon Hose

Stainless steel Teleflex medium pressure, smooth bore Teflon lined hose.



Part#	Description
HYDHT8	1/2"
HYDHT12	3/4"

Flow Control Valve

Part# HYDVFC

Cast iron body, 25 GPM valve, with 1" ORB and pressure relief on inlet.



Kurlyama Temp-Tech 300 F Hoses

Single or double braid wire. Meets or exceeds SAE 100 R1AT (single braid) and SAE 100 R2AT (double braid). Single braid available in sizes 3/8" through 1-1/4" ID. Double braid available in sizes 1/4" through 2" ID.

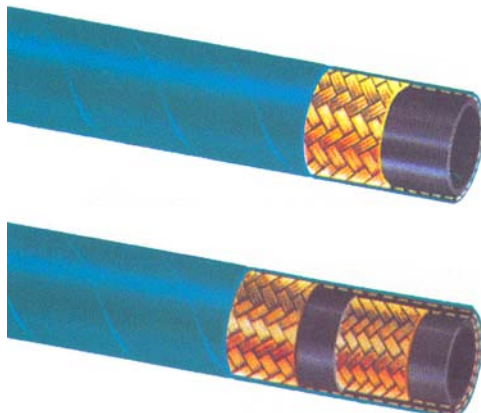

Alfatech Constant Working Pressure Hoses

The Alfatech series of hoses, designed with the application engineer in mind, simplifies system routing by offering the same working pressure ratings for all sizes of the respective hose.



DBL can install
or modify any existing
hydraulic system or other
to meet the needs of its customers.
Call to see what we can offer
your company.

Competitor's Work



DBL's Work

